

FLEXIBLE LED LUMIFLEX™ LED SIMULATED NEON



High Intensity Flexible LED Accent Lighting

FEATURES

- Dot-free linear neon-like illumination
- Fabricated with Eco-friendly, UV-resistant silicone material
- V-2 flame retardance
- Flexible PCB with SMD LED technology
- 24V DC low voltage, safe and reliable
- Cutting mark by every 1.97in
- cULus Listed, CE RoHS certified
- 5-year manufacture warranty
- Min. bending diameter **1.97in**

5-YEAR WARRANTY

DETAILS

Input	100-240 VAC
Output	24 VDC
Max. Load Footage	49 ft.
Watts per Foot	3.10
Dimming Capable	Yes
Bending Parameters	1.97in.
Limited Warranty Terms	5 Years
Materials	Silicone
Dimensions	1.00 x 0.40
Certification	cULus E335482, CE

APPLICATIONS

- Signage lighting
- Outdoor/indoor decoration lighting
- Contour application
- Channel Letters

SPECIFICATIONS

Part No./ Color	Footage	Wattage per foot	Lumens per foot	Number of LEDs/ft.
600-1006 White 6500K	49	3.10	150	36
600-1056 White 4000K	49	3.10	150	36
600-1005 White 3000K	49	3.10	150	36
600-1000 Red	49	3.10	-	36
600-1004 Orange	49	3.10	-	36
600-1003 Golden Rod	49	3.10	-	36
600-1002 Green	49	3.10	-	36
600-1001 Blue	49	3.10	-	36

*LumiFlex systems based on Mean Well 185W, 24 VDC, LED Driver HLG-185H-24A

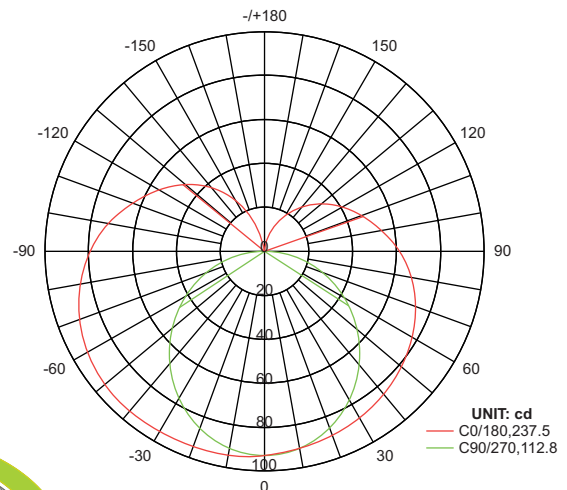

PROFILE AND MINIMUM BEND DIAMETER

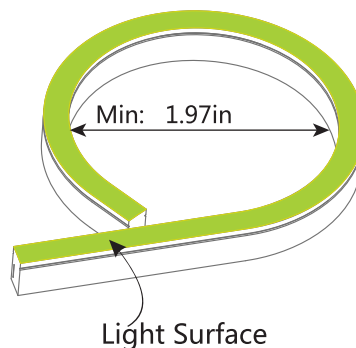
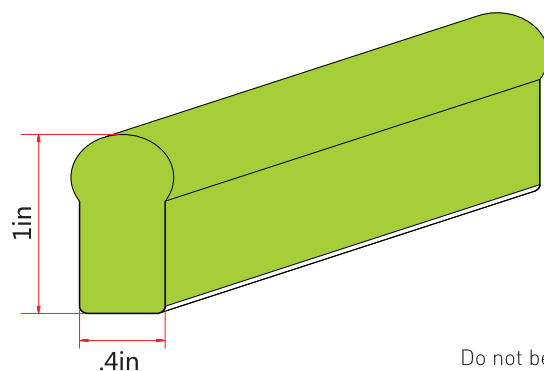

Do not bend smaller than allowed minimum bend diameter.





918.622.4978

www.lektroninc.com
sales@lektroninc.com

FLEXIBLE LED LUMIFLEX™ LED SIMULATED NEON

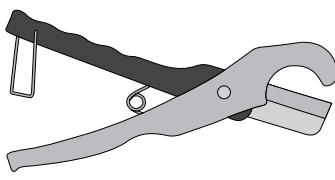
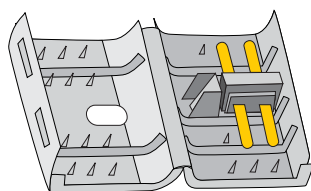
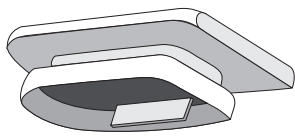
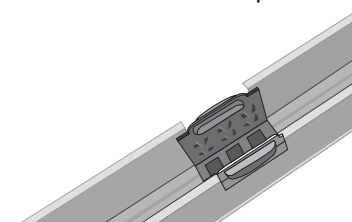
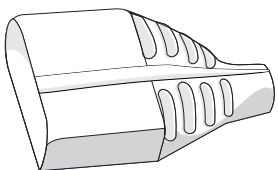
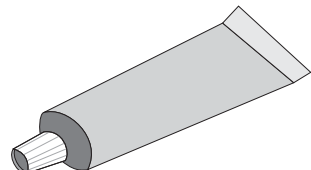

LUMIFLEX INSTALLATION MATERIALS

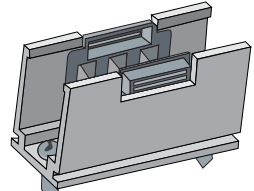
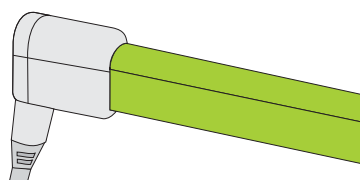
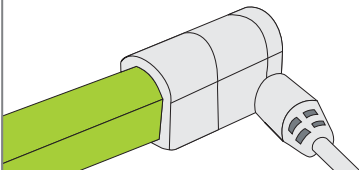
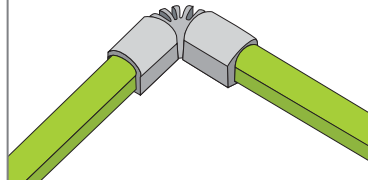
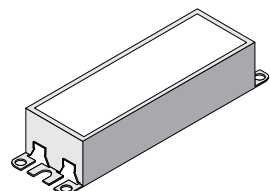
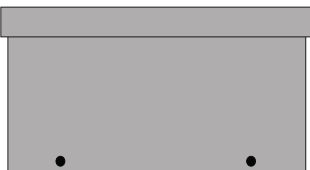
<p>700-1035</p> <p>Flexible LED Neon Cutter & File Set</p> 	<p>700-1008</p> <p>LumiFlex Interconnect Set *Upon Request</p> 	<p>700-1009</p> <p>LumiFlex Click-In End Cap *Upon Request</p> 	<p>700-1013</p> <p>36.25" Aluminum Mounting Channel w/ 3 clips</p> 
<p>700-1007-S</p> <p>Soldered Input Power Connector Set</p> 	<p>700-1016</p> <p>Silicone Adhesive</p> 	<p>700-1012</p> <p>Silicone End Cap</p> 	<p>700-1010</p> <p>1-3/8" Aluminum Mounting Clip</p> 
<p>700-1015</p> <p>Quick Input Power Connector Set (bottom) *Upon Request</p> 	<p>700-1014</p> <p>Quick Input Power Connector Set (side) *Upon Request</p> 	<p>700-1011</p> <p>L-Bend Connector Set *Upon Request</p> 	<p>185-1966</p> <p>Mean Well 185W 24VDC LED Driver</p> 
<p>185-0154</p> <p>J-Box</p> 			



918.622.4978

www.lektroninc.com
sales@lektroninc.com

FLEXIBLE LED LUMIFLEX™ LED SIMULATED NEON



TYPES OF LED FLEX

2 Neon light options, only different on the connectors. You may choose any for your project.

N2-4

B. With Silicone End Fitting Version

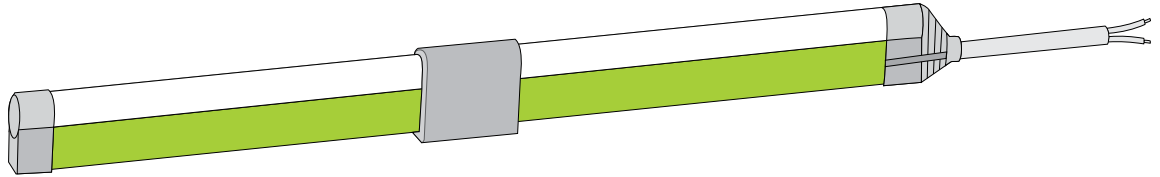

TYPES OF CONNECTORS

Linear Reconnector

Connects two pieces of light together with the re-connection kits. IP67 Connectors

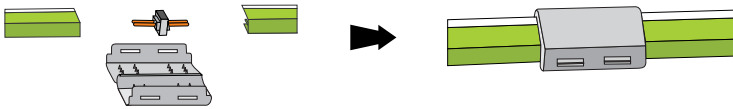

L Shape Reconnector

Connects two pieces of light together with a L joint. IP67 Connector.

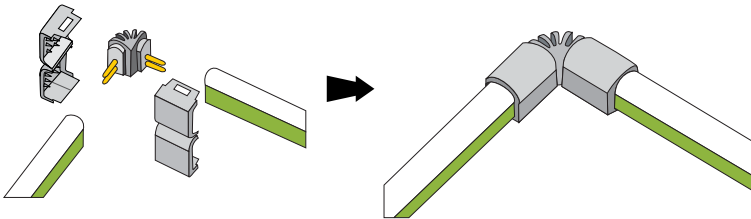

End Cap

Termination protection of the light. IP67

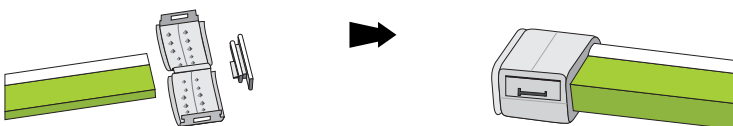

MOUNTING CHANNEL

Self-locking Aluminum Mounting Channel

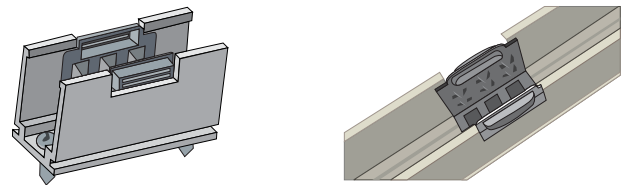

Standard Length

Part Number

1.4 inch

39.37 inch

Fixed Channel without Light

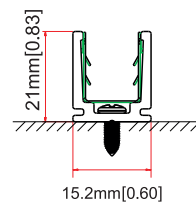

Fixed Channel with Profile Light

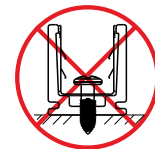
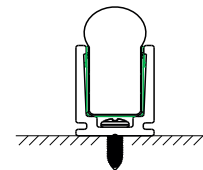

918.622.4978

www.lektroninc.com
sales@lektroninc.com

FLEXIBLE LED LUMIFLEX™ LED SIMULATED NEON



END CAPS INSTALLING GUIDE (STEP 1-STEP 5)

Step 1

End cap structure

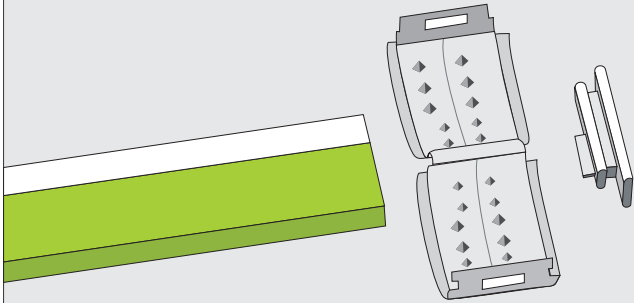

Step 2

Insert the end cap into the strip

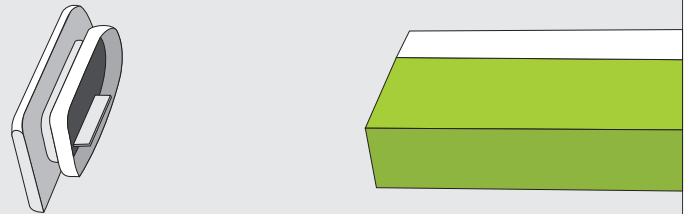

Step 3

Put silicone at the joint of strip and the housing

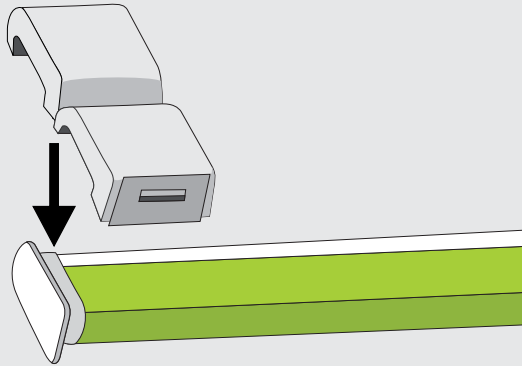

Step 4

Close the housing after silicone

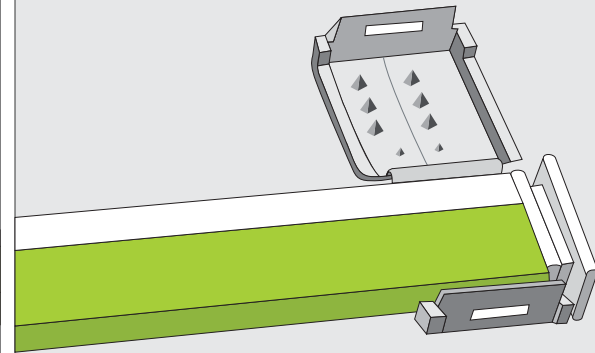

Step 5

Final end cap picture

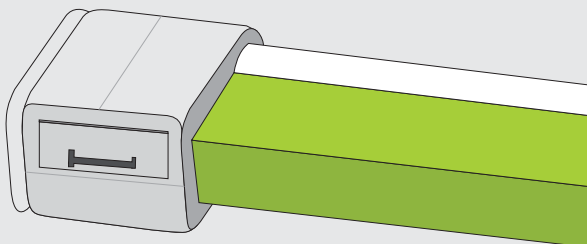

918.622.4978

www.lektroninc.com
sales@lektroninc.com

FLEXIBLE LED LUMIFLEX™ LED SIMULATED NEON



RE-CONNECTOR INSTALLING GUIDE (STEP 1-STEP 5)

Step 1

Re-connector structure

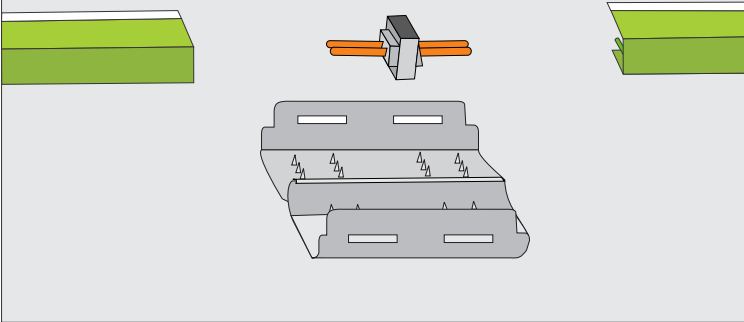

Step 2

Insert the pin into the strip (NOTE: Pin on the back of PCB)

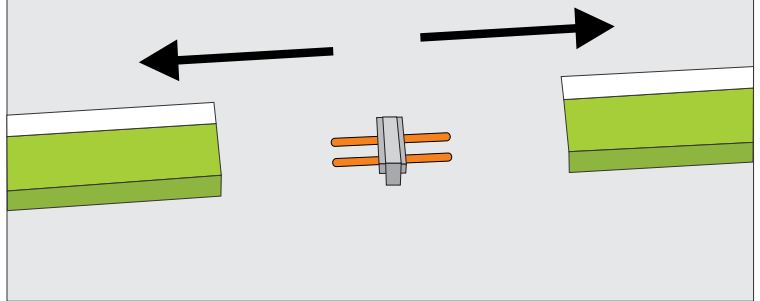

Step 3

Put silicone at the joint of strip and the housing

WARNING: Make sure the pins are inserted on the copper side.

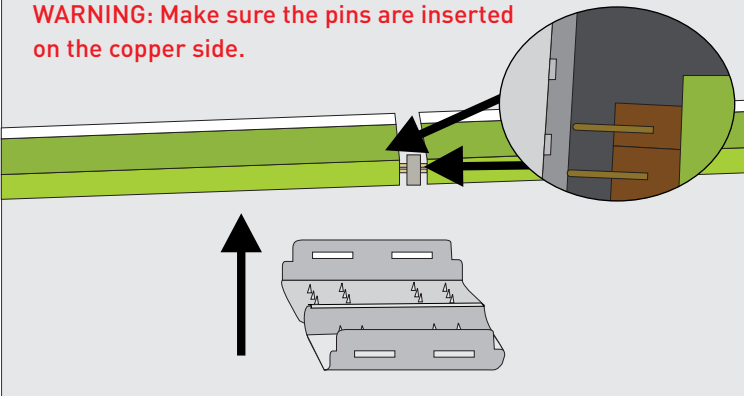

Step 4

After silicone, close the housing

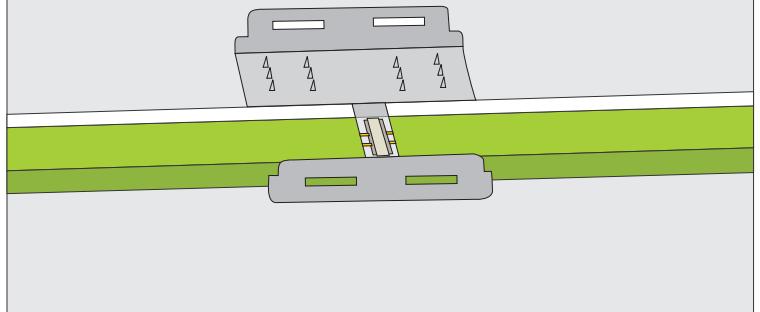

Step 5

Final re-connection picture

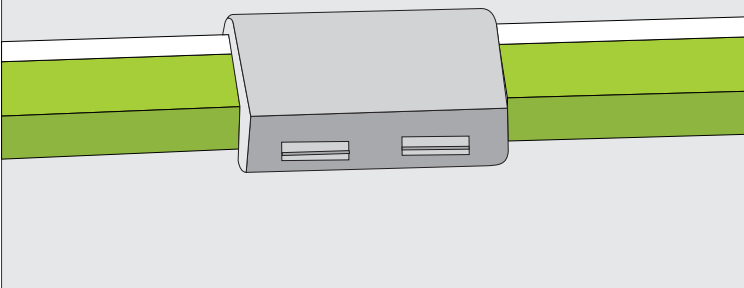

918.622.4978

www.lektroninc.com
sales@lektroninc.com

FLEXIBLE LED
LUMIFLEX™
 LED SIMULATED NEON



END CAP INSTALLING GUIDE (STEP 1-STEP 3)

<p>Step 1 End Cap structure</p>	<p>Step 2 Apply Silicone at the end of strip, put on the end cap.</p>	<p>Step 3 Final End Cap Picture</p>
--	--	--

WARNING

<p>No Twisted operation</p>	<p>Cutting profile should be flat</p>	<p>No flexing horizontally</p>
<p>Cutting mark</p>	<p>No 90° bending</p>	<p>No bending repeatedly</p>

NOTE: Scissor marks are just a guide. LEDs under silicone can vary PAST the scissor marks. Add approximately 0.5" of extra material to overall length. (example: 20' section would be 20.5" to allow room for error)

FLEXIBLE LED
LUMIFLEX™
LED SIMULATED NEON



WARNING:

YOU MUST KEEP THE PRODUCT SUPPORTED DURING INSTALLATION. DO NOT LET IT HANG DOWN DURING INSTALLATION. FAILING TO DO SO COULD RESULT IN AN OUTAGE.

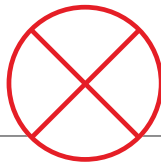

Installing it this way will void the warranty

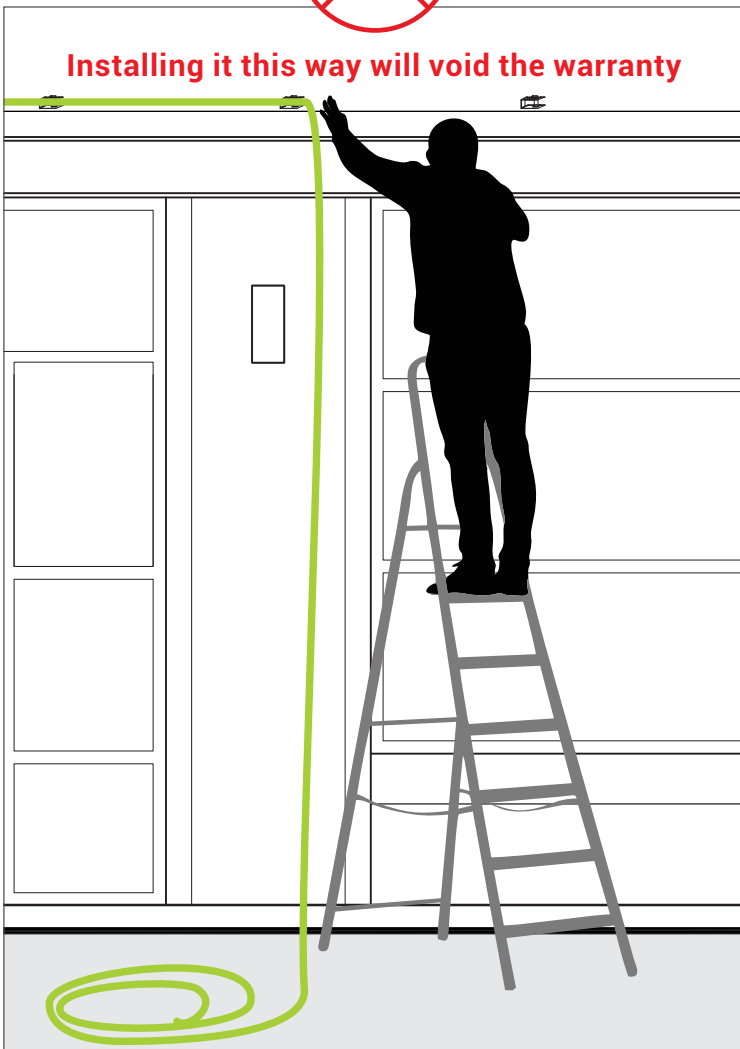

Holding the product this way keeps it supported

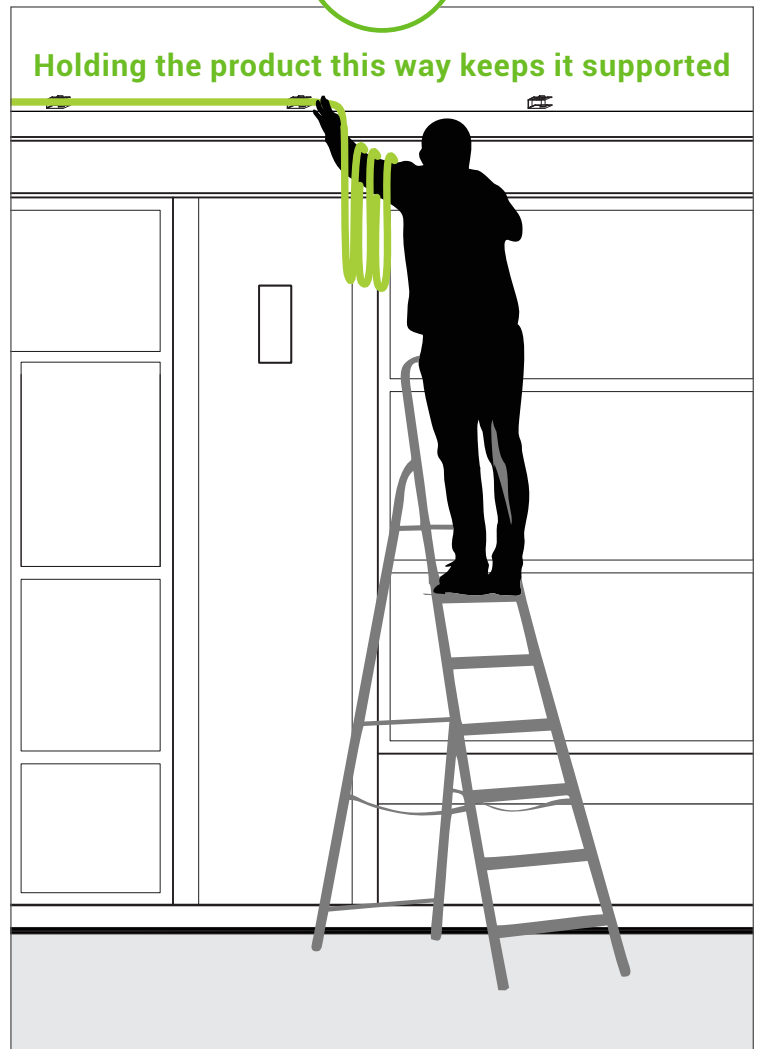

918.622.4978

www.lektroninc.com
sales@lektroninc.com